

ARE YOU STARTING A MEDICAL PRACTICE?

Feel Free to Print this Sheet Out to Help with Your Office Planning :)

HERE IS WHAT YOU NEED!

Sample Layout of General Medical Practice

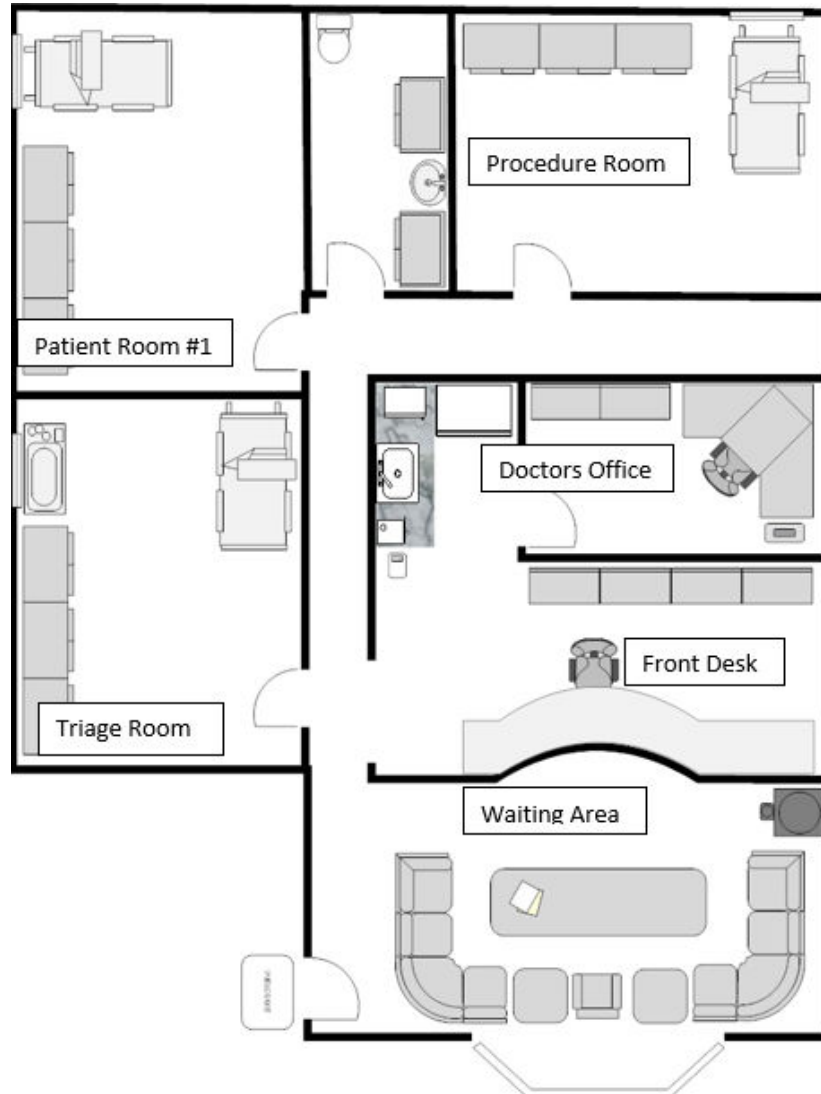

Tips and Other Information

- Most of the items that we do not carry (Desks, Cabinets, Shelving, Sinks, etc.) are most easily found and most cost-effective at your local Lowes or Home Depot
- Most Doctors or Startup Owners tend to get at least one Power Exam Table or Power Procedure Chair per office to help facilitate larger or less mobile clients, this also helps the efficiency and effectiveness of procedures
- Every Medical Office Must have an AED on site
- Finding a Local Biomed Tech is important as you will have to have your items certified and tested once every year
- When purchasing equipment it is best to go ahead and find the user manual online and download it to your computer, so down the road you can troubleshoot it if need be

Here is What You Need Below

- **Waiting Room**
 - Waiting room chairs
 - Books/Magazines, End/Corner Tables, Lamps
- **Front Desk**
 - AED
 - Computer Carts
 - Stools
 - Computer, Phone
- **Doctors Office**
 - Stools
 - Computer, Desk, Office Supplies, Shelving
- **Triage/Medical Assistant Prep Room**
 - Audiometer
 - Computer Carts
 - EKG
 - Exam Table
 - Guest Seating
 - Lab Chair
 - Otoscope
 - Scale
 - Stools
 - Vitals Monitor
 - Workstation on Wheels
 - Exam Instruments, PPE, Sink and Cabinet
- **Patient Room #1 (Exam Room)**
 - Biohazard Bin
 - Exam Light
 - Exam Table
 - Guest Seating
 - IV Pole
 - Mayo Stands
 - Otoscope
 - Sharps Container
 - Stools
 - Workstation on Wheels
 - Exam Instruments, PPE, Sink and Cabinet
- **Procedure Room**
 - Biohazard Bin
 - Computer Cart
 - Exam Light
 - IV Pole
 - Mayo Stands
 - Otoscope
 - Power Exam Table/Procedure Chair
 - Sharps Container
 - Stools
 - Vitals Monitor
 - Workstation on Wheels
 - Exam Instruments, PPE, Sink and Cabinet
- **Other Items That May Be Needed**
 - Autoclave
 - Break Room Appliances
 - Centrifuge
 - Emergency Equipment and Supplies
 - Specialized Equipment (ESU systems, hyfercator, ultrasounds, spa/aesthetic equipment)
 - Step Stools
 - Wheelchair

Order Form

Item Type	Qty Needed	Specific Model Preferred
Exam Tables		
Power Exam Tables		
Power Exam Chairs		
Doctors Stools		
Lights		
AED		
Otoscope/Otoscope Wall Boards		
Med Carts		
Vitals Monitors		
EKGs		
Scales		
Lab Chairs		

Other Items that May Be Needed (Circle and Qty all That Apply):

Autoclave, Biohazard Bin, Audiometer, Sharps Containers, Waiting Room Chairs, Wheelchair, Med Spa Chairs, Centrifuge, Mayo Stands, IV Pole, Workstation on Wheels, Pediatric Table, Hyfreator, ESU Units, Colposcope

Full Delivery Address for Third Party Shipping Quote:

Shipping Information

- There are three main types of shipping: Freight Shipping, Inside Blanket Wrapped Delivery, and Self Pickup
- With Freight Shipping all the items are going to arrive curbside on a pallet and you are responsible for bringing them into your space
- With Inside Blanket Wrapped Delivery the items will arrive blanket wrapped, and the driver and passenger will bring them into your space for you
- With Self-Pickup we can help you load the items on our end and it is free of charge!